



APPLICATIONS

- For direct installation into the process
- Bearing
- Machine building
- Motors
- Pipelines and vessels

SPECIFICATIONS

Type	Materials
PT-4 (Straight)	Stainless steel insert/ process connection
PT-5 (Angled)	Carbon steel head with orange polyester varnish
	Teflon cable
Accuracy class	
Standard class A*	
Scale ranges	Process connection
-100 °C / +650°C	1/2" BSP, other connections on request

DESCRIPTION

Resistance thermometers are particularly suitable for those applications in which the metal sensor tip is mounted directly into bored holes (e.g. in machine components) or directly into the process for any application with no chemically aggressive media or abrasion.

Mounting is usually directly into the process. Fastening elements such as threaded fittings, union nuts, etc. can also be used. The measuring resistor is connected directly to the internal leads of the sheathed cable and is, therefore, also suitable for use at higher temperatures.

Due to their flexibility and the small possible diameters, sheathed resistance thermometers can also be used in locations that are not easily accessible, since, with the exception of the sensor tip and the transition sleeve of the connection cable, the sheath can be bent to a radius of three times the diameter of the cable.

FEATURES

- Sensor ranges from -100...650°C (-148...1202°F)
- For insertion, screw-in with optional process connection
- Connection head straight or angled

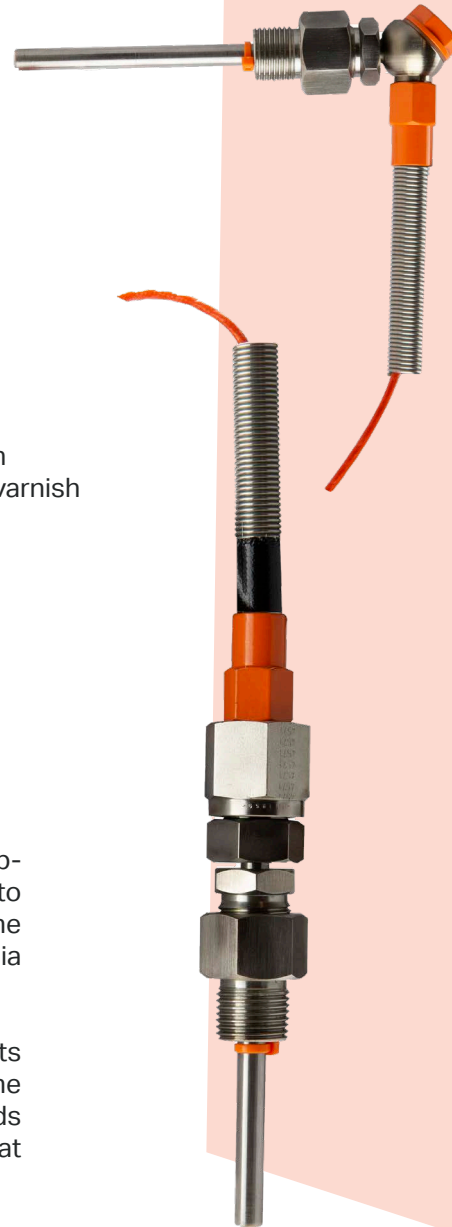

PT-4/5 RESISTANCE THERMO
METER (STRAIGHT / ANGLED)

OPTIONS

- Accuracy class B or AA available on request*
- Calibration certificate (national and international standards)

TYPE

PT-4/5 resistance thermometer (straight / angled)

CONNECTION METHOD

Single elements | 1 x 3-wire
1 x 4-wire

SENSOR

Pt-100

METAL PROBE

Material: Stainless steel
Diameter: 6*, 8, 10, 12 or 15 mm
Length: Selectable

*Only possible for thermometers without thermowell

Electrical connection (colour code per IEC/EN 60751)

Teflon insulated cable with flying leads.

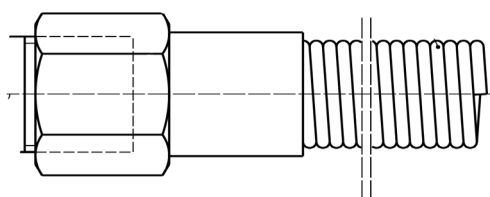

made of carbon steel and painted with varnish polyester RAL 2003 half gloss

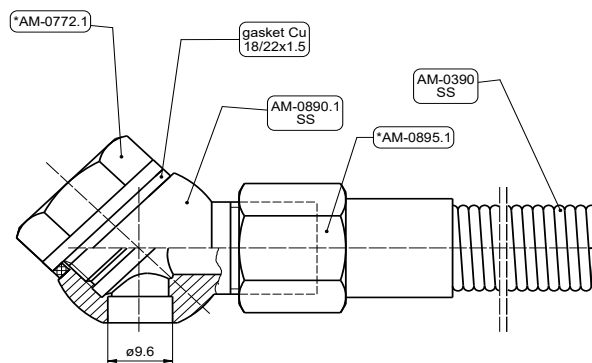

* made of carbon steel and painted with varnish polyester RAL 2003 half gloss

Model: PT-4: Straight version with cable protecting spring Model: PT-5: Angled version with cable protecting spring

CONNECTION HEAD

MODEL	MATERIAL	SURFACE	SPRING	MIN. / MAX. AMBIENT TEMPERATURE
Straight / Angled	Carbon steel	Orange, Polyester varnished	Stainless steel	-40 / +80 °C

TYPE

PT-4/5 resistance thermometer (straight / angled)

Item	Code	Notes	XXX	X	X	XX	XX	XXX	X	X
Product Straight resistance thermometer Angled resistance thermometer	PT4 PT5									
Configuration Spring protected leads	X									
Measuring Element 3-wire 4-wire	3 4									
Maximum temperature 200°C 550°C	LT HT									
Insert diameter 6 mm 8 mm 10 mm 12 mm 15 mm	06 08 10 12 15									
Insert length - L Specify length in mm (3 digits)	xxx									
Sliding coupling connection No connection, plain stem G 1/2" 1/2"NPT M20 x 1,5 M27 x 2 G3/4" Other connection	X A B C D E Z	(Please specify!)								
Fixed thread connection G 1/2" G 1/4" 1/2" NPT G 3/4" Other connection	1 2 3 4 0	(Max. 8 mm insert) (Please specify!)								
Cable length Specify length in meters	x									